

St Albans Office
10 High Street, St Albans
Herts AL3 4EL
01727 228428
stalbans@cassidyandtate.co.uk

Marshalswick Office
59 The Quadrant, St Albans,
Herts AL4 9RD
01727 832383
marshalswick@cassidyandtate.co.uk

Wheathampstead Office
39 High Street, Wheathampstead,
Herts AL4 8BB
01582 831200
wheathampstead@cassidyandtate.co.uk

Cassidy
& Tate
Your Local Experts



Award Winning Agency



www.cassidyandtate.co.uk

WINDERMERE AVENUE

ST. ALBANS

AL1 5QW

Price Guide £765,000

EPC Rating: D Council Tax Band:



All The Ingredients Needed For A Fabulous Lifestyle

Welcome to Windermere Avenue, St. Albans - a charming location that could be the perfect setting for your new home! This 1930s original semi-detached house offers a fantastic opportunity for those looking to take on a refurbishment project. With two reception rooms and three bedrooms, this property provides ample space for comfortable living. One of the standout features of this property is its proximity to the mainline train station, making commuting a breeze for those working in the city. Additionally, the potential to extend the property, subject to planning permission, opens up a world of possibilities to create your dream home.

Being chain-free, this property offers a smooth and hassle-free buying process. Don't miss out on the chance to transform this house into a beautiful home with your personal touch. Windermere Avenue is calling - are you ready to make it your own?

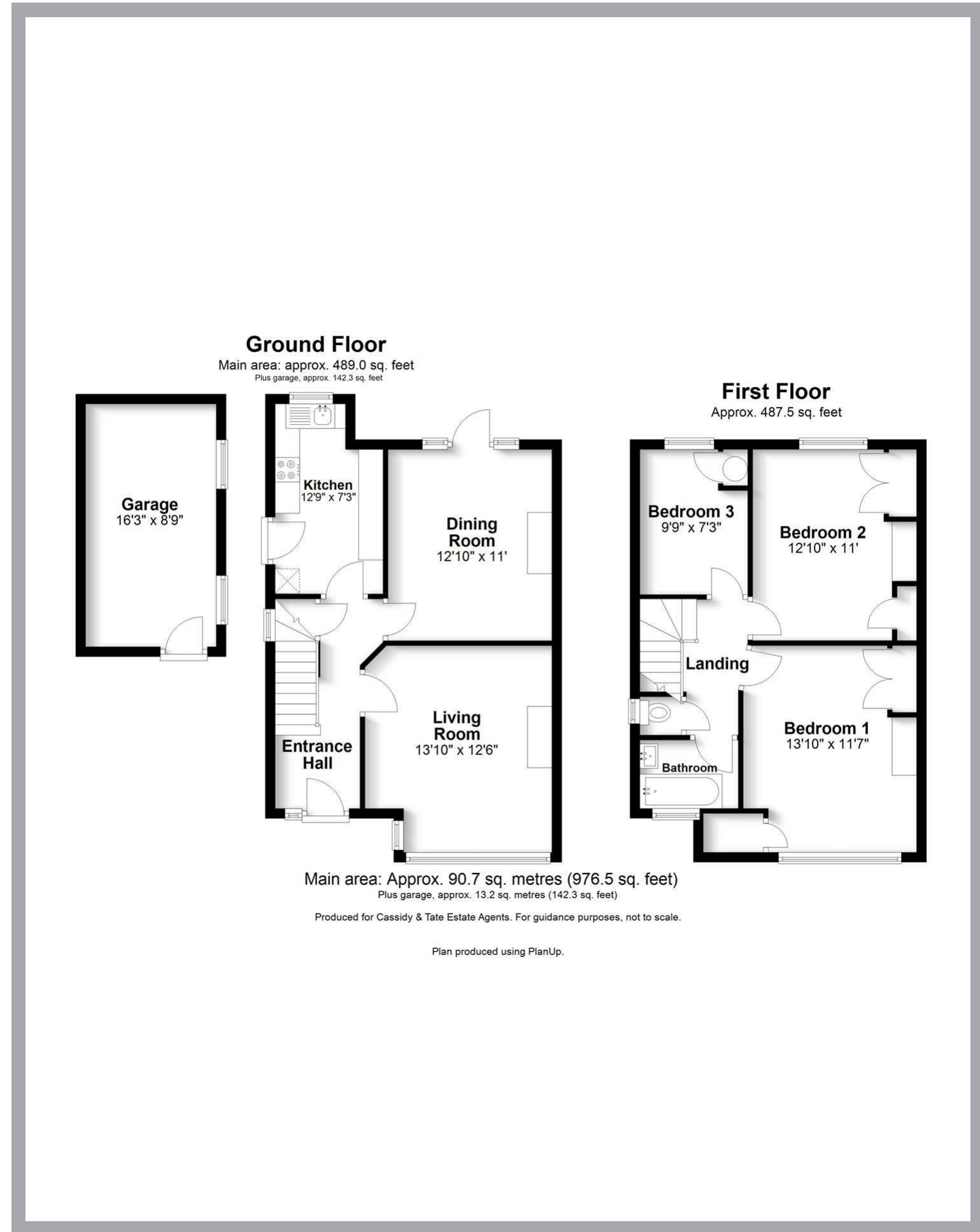

Perfect Fusion of Location And Way of Living



Why Cassidy & Tate

Cassidy & Tate are a fully independent estate agent who have developed unparalleled understanding on how people want to buy, sell and rent property within the residential property market in Hertfordshire and its surrounding areas. We are able to accommodate your individual requirements and deliver to you a more personalised service, tailored to your home buying, selling and letting needs.

We also have many years of experience in land and new homes and the pleasure of working alongside many reputable house builders and developers in Home Counties and Greater London. Whether you are looking to acquire or sell development opportunities and land, wish to purchase or sell a newly built or refurbished property, or require a site valuation and marketing advice we can help.

Your Local Property Experts

As one of St. Albans leading estate agents we work relentlessly to ensure our valued customers receive the exceptional service they deserve at all times. We epitomise not only professional estate agency knowledge, but a dedication to integrity and responsiveness to every client. The Cassidy & Tate team will be available to you when in need to help overcome any stressful situations that may arise. We are here to offer you valuable and honest advice when needed so that you can navigate the best path through the process. We know the marketplace, the buyers, the sellers and neighbourhoods, but most importantly we know how to put our clients' needs first. Our state of the art sales tools, modern technology and our own in-house fully independent Mortgage Broker is here to make your journey easier and more direct to your final goal. At Cassidy & Tate you will be in control of your sale or purchase and we will help you get the best result possible



Specialists in Bespoke Properties

- Chain Free
- Scope To Extend stpp
- Close To Station
- Private Driveway
- Original 3 Bed Semi
- Ideal For Modernisation
- Large Rear Garden
- Detached Garage

| Energy Efficiency Rating | |
|---|-----------|
| Current | Potential |
| Very energy efficient - lower running costs | |
| (92 plus) A | |
| (81-91) B | |
| (69-80) C | |
| (55-68) D | |
| (39-54) E | |
| (21-38) F | |
| (1-20) G | |
| Not energy efficient - higher running costs | |
| 63 | 87 |
| EU Directive 2002/91/EC | |

| Environmental Impact (CO ₂) Rating | |
|---|-----------|
| Current | Potential |
| Very environmentally friendly - lower CO ₂ emissions | |
| (92 plus) A | |
| (81-91) B | |
| (69-80) C | |
| (55-68) D | |
| (39-54) E | |
| (21-38) F | |
| (1-20) G | |
| Not environmentally friendly - higher CO ₂ emissions | |
| EU Directive 2002/91/EC | |

